

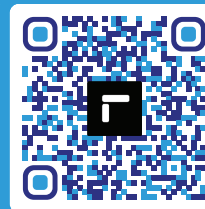

ROCKLESS TABLE

TABLE BASE ASSEMBLY INSTRUCTIONS.



Assembly Instructions

CONGRATULATIONS ON ENDING WOBBLY TABLES FOREVER!

The assembly of Rockless Table bases is extremely simple. Follow the detailed instructions below to ensure proper performance of your table base.

If you still need help, scan the QR code located at the top right corner of this document to go to our website for more videos and instructions.



1

INSERT THE INNER TUBE INTO THE OUTER TUBE AND ALIGN THE BOLT HOLES.

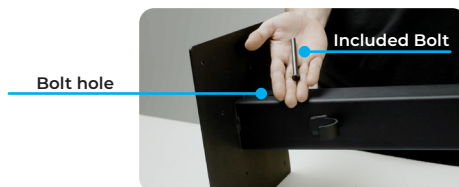

2

INSERT THE INCLUDED BOLT INTO THE BOLT HOLE AND SECURE THE BOLT WITH AN ALLEN WRENCH (INCLUDED).

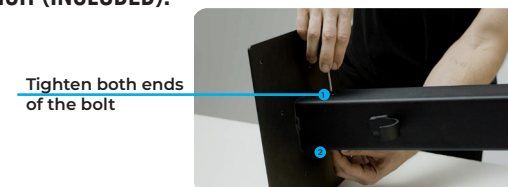

3

SCREW THE INCLUDED BRAKE KNOB INTO THE BOTTOM OF THE TABLE BASE.

NOTE: In most cases, there is no need to adjust the brake knob. It is perfectly fine to leave the knob untightened, unless you are relocating your table bases. Tightening the knob during the movement is recommended to prevent any damage while relocating.

Once placed in the new location, loosen the knob and let the table base self-adjust.



4

YOU'RE DONE!

TAG US ON SOCIAL MEDIA TO BE A FEATURED PARTNER!.

  @ROCKLESSTABLE



PLEASE TAKE 30 SECONDS TO LEAVE US A REVIEW.

IF YOU HAVE ANY QUESTIONS, PLEASE CALL OR EMAIL US.

**INFO@ROCKLESSTABLE.COM
888-444-7124.**